

FERRULE

INSTALLATION INSTRUCTIONS

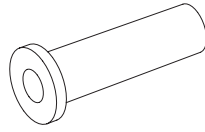

For use on any irregular surfaces including: wood, aluminum, vinyl, hardboard, brick, masonry, stone.

Required for Installation:

- Electric drill, 1/4" drill bit, 3/8" drill bit, hammer, Shutter-Loks, and Ferrule.

Step 1

Place the shutter next to the window and mark desired location against the wall or window.

Step 2

With the shutter in location against the wall, drill through the shutter into the wall 2 1/2" deep. In brick, the hole dia. should be no greater than .250 inches and positioned over mortar joints. Do not attach the shutter at this time.

Step 3

With the 1/4" holes drilled into the shutter and wall, remove the shutter from the wall. Enlarge the holes in the shutter by using a 3/8" drill bit.

Step 4

Place the Ferrule behind the shutter, lined up with the holes that have been drilled for the Shutter-Loks. Trim the Ferrule to properly fit the gap between the back of the shutter and the wall it is being attached to. The Ferrules may not all be the same length. Shutter Loks used in masonry must penetrate at least 7/8" into the wall.

Step 5

Once the Ferrule is trimmed to the desired length and the shutter is parallel to the wall, insert the Shutter-Lok into the hole in the shutter and through the Ferrule going into the wall. Tap the Shutter Lok gently with a hammer to snug the shutter to the siding. Do not over tighten, or this will cause the shutter to dimple. (See Fig. 1)

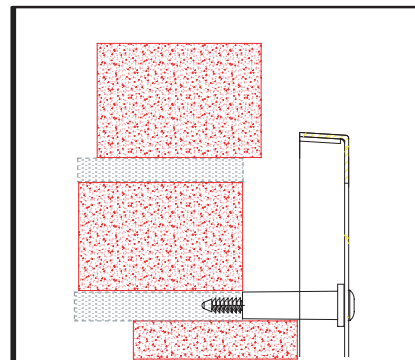
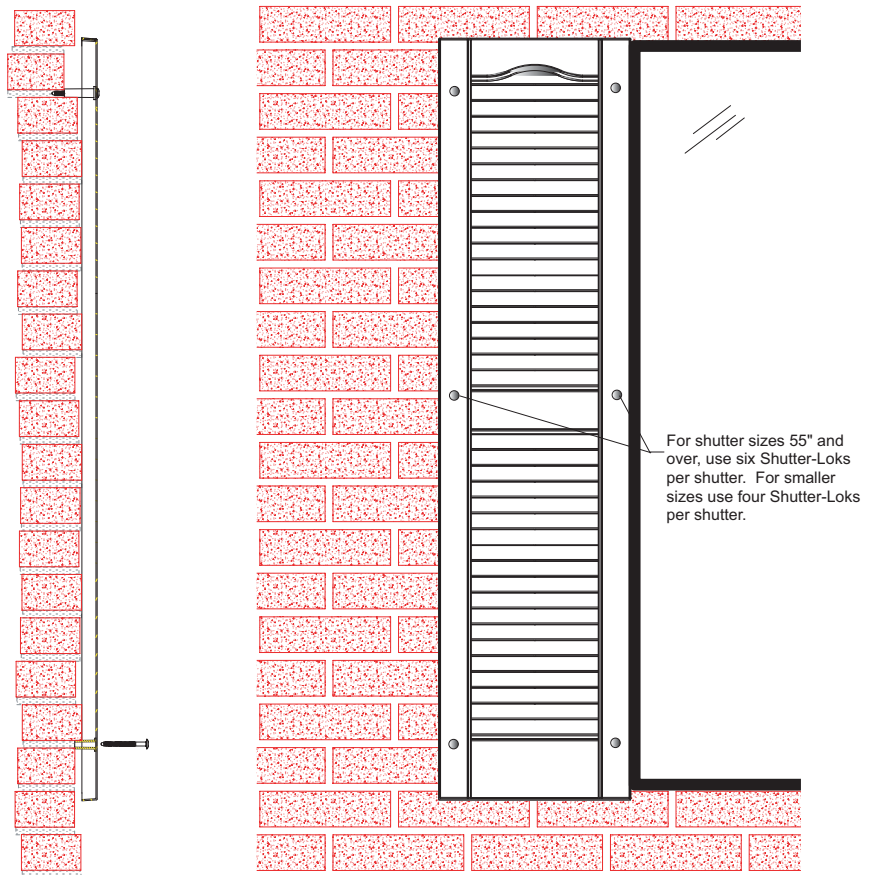

Fig. 1